

Cu Preskabelsko - med 2 huller

Cu PRESSKABELSCHUHE MIT 2 LASCHENBOHRUNGEN
Cu COMPRESSION CABLE LUGS WITH 2 PALM HOLES

 6 kt. presning

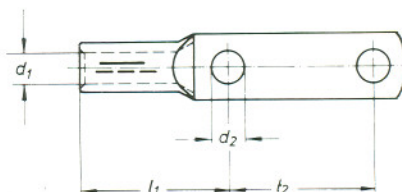

Bestillings nr.	mm ²	Laske- boring d ₂	Kode- tal	Leder Ømm	d ₁	mm l ₁	l ₂	El nr.	Internt nr.
50x2x10 KU	50	10,5	14	9,0	10,0	50	30	95 21 001 343	
50x2x12 KU		13,5				50	50	95 21 001 356	
70x2x10 KU	70	11,0	16	10,5	11,5	55	24	95 21 001 369	
70x2x12 KU		13,5				55	50	95 21 001 372	
95x2x12 KU	95	13,5	18	12,5	13,5	65	50	95 21 001 385	
120x2x12 KU	120	13,5	20	14,0	15,5	70	50	95 21 001 398	
120x2x12 KU60						70	60	95 21 001 408	
150x2x12 KU	150	13,0	22	15,7	16,5	75	26	95 21 001 411	
185x2x12 KU	185	13,0	25	17,5	18,5	82	26	95 21 001 424	
240x2x16 KU	240	17,0	28	20,2	21,0	90	50	95 21 001 437	
300x2x16 KU	300	17,0	32	22,5	24,5	104	40	95 21 001 440	
500x2x12 KU	500	14,0	42	29,1	31,0	126	40	95 21 001 453	
500x2x16 KU		17,0				126	50	95 21 001 466	
1000x2x16 KU	1000	17,0	58	41,1	44,0	160	50	95 21 001 479	

Større mm² på forespørgsel



Cu Preskabelsko - med inspektionshul - fortinnet

Cu PRESSKABELSCHUHE MIT SCHAULOCH - VERZINNT
Cu COMPRESSION JOINTS WITH SIGHT HOLE - TIN-PLATED



6 kt. presning



Dorn presning

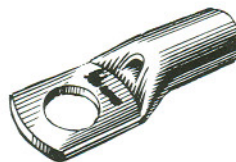

Bestillings nr.	mm ²	Laskeboring a	d	l	El nr.	Internt nr.
0,75-3	0,5	3,2	1,3	16,0	95 21 318 803	
0,75-4	0,75	4,3	1,3	16,0	95 21 318 900	
1,5-3	1,5	3,2	1,8	16,0	95 21 319 006	
1,5-4		4,3	1,8	17,0	95 21 319 103	
1,5-5		5,3	1,8	18,0	95 21 319 200	
2,5-3	2,5	3,2	2,3	16,0	95 21 319 307	
2,5-4		4,3	2,3	17,0	95 21 319 404	
2,5-5		5,3	2,3	18,0	95 21 319 501	
2,5-6		6,5	2,3	19,0	95 21 319 608	
4-4	4	4,3	3,0	21,0	95 21 319 705	
4-5		5,3	3,0	22,0	95 21 319 802	
4-6		6,5	3,0	23,0	95 21 319 909	
6-4	6	4,3	4,0	21,0	95 21 320 008	
6-5		5,3	4,0	22,0	95 21 320 105	
6-6		6,5	4,0	23,0	95 21 320 202	
6-8		8,5	4,0	30,0	95 21 320 309	
10-5	10	5,3	5,0	28,0	95 21 320 406	
10-6		6,5	5,0	28,0	95 21 320 503	
10-8		8,5	5,0	32,0	95 21 320 600	
10-10		10,5	5,0	33,0	95 21 320 707	
16-6	16	6,5	6,0	31,5	95 21 320 804	
16-8		8,5	6,0	31,5	95 21 320 901	
16-10		10,5	6,0	38,0	95 21 321 007	
16-14		14,0	6,0	46,0	95 21 321 104	
16-17		17,0	6,0	53,0	95 21 321 201	
25-6	25	6,5	8,0	37,0	95 21 321 308	
25-8		8,5	8,0	38,0	95 21 321 405	
25-10		10,5	8,0	42,0	95 21 321 502	
25-14		14,0	8,0	50,0	95 21 321 609	
25-17		17,0	8,0	56,0	95 21 321 706	
35-6	35	6,5	9,0	44,0	95 21 321 803	
35-8		8,5	9,0	44,0	95 21 321 900	
35-10		10,5	9,0	44,0	95 21 322 006	
35-14		14,0	9,0	52,0	95 21 322 103	
35-17		17,0	9,0	62,0	95 21 322 200	

Fortsættes næste side



Cu Preskabelsko - med inspektionshul - fortinnet

Cu PRESSKABELSCHUHE MIT SCHAULOCH - VERZINNT
Cu COMPRESSION JOINTS WITH SIGHT HOLE - TIN-PLATED

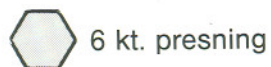

6 kt. presning



Dorn presning

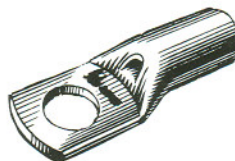

Bestillings nr.	mm ²	Laskeboring a	d	l	El nr.	Internt nr.
50-8	50	8,5	11	49	95 21 322 307	
50-10		10,5	11	49	95 21 322 404	
50-14		14,0	11	55	95 21 322 501	
50-17		17,0	11	62	95 21 322 608	
70-8	70	8,5	13	58	95 21 322 705	
70-10		10,5	13	58	95 21 322 802	
70-14		14,0	13	58	95 21 322 909	
70-17		17,0	13	63	95 21 323 005	
95-10	95	10,5	15	69	95 21 323 102	
95-14		14,0	15	69	95 21 323 209	
95-17		17,0	15	69	95 21 323 306	
120-10	120	10,5	17	72	95 21 323 403	
120-14		14,0	17	72	95 21 323 500	
120-17		17,0	17	72	95 21 323 607	
150-14	150	14,0	19	81	95 21 323 704	
150-17		17,0	19	81	95 21 323 801	
150-20		20,0	19	81	95 21 323 908	
185-14	185	14,0	21	89	95 21 324 004	
185-17		17,0	21	89	95 21 324 101	
185-20		20,0	21	89	95 21 324 208	
240-14	240	14,0	24	99	95 21 324 305	
240-17		17,0	24	99	95 21 324 402	
240-20		20,0	24	99	95 21 324 509	
300-20	300	20,0	26	114	95 21 324 606	
300-24		24,0	26	114	95 21 324 703	
400-20	400	20,0	30	118	95 21 324 800	
400-24		24,0	30	118	95 21 324 907	

